

FRONT ELEVATION

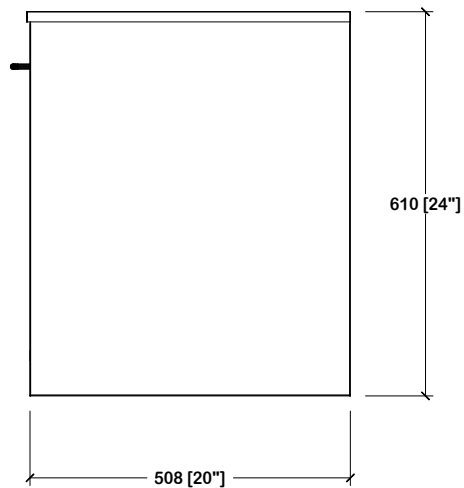

END VIEW

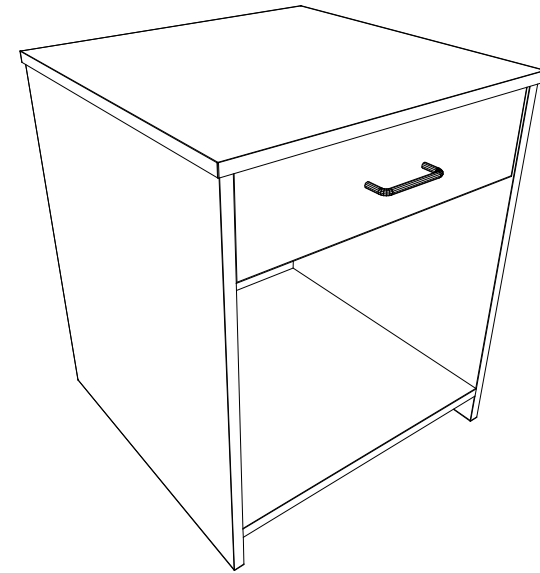

ISOMETRIC VIEW

MATERIAL SPECIFICATIONS

CABINET:	16MM LOW PRESSURE LAMINATE W/ 1MM EDGING - WHITE
PULL:	96MM D PULL - BRUSHED NICKEL
DRAWER SLIDE:	POWDER COATED METAL W/ NYLON ROLLERS
DRAWER BOXES:	16MM LOW PRESSURE LAMINATE - 'WHITE'
LOCKS (OPTIONAL):	COMPX NATIONAL - NICKEL
CASTERS (OPTIONAL):	2" DUAL-WHEEL - BLACK



404 Prospect Ave, Osborn, SK, S0C 2B0
Tel +1 306-483-5118 Fax +1 306-483-2102 Email: design@bowwood.net

DRAWING DETAIL		DRAWING NAME	
MEDICAL BEDSIDE CABINET - DRAWER		M0055D	
DRAWN BY	DATE	SCALE	VIEW
W.S.	04/02/20	N.T.S.	AS SHOWN

© Copyright of Bow Wood Cabinet Systems. All Rights Reserved. No part of this drawing may be reproduced or distributed in any form without prior written permission from Bow Wood Cabinet Systems.